

## FEATURES ↴

- 8 Single-Family Homes
- Modern Design
- 2-3 Bedrooms
- 3-3.5 Bathrooms
- 1,457-1,799 SqFt
- 2-Car Garages
- Private Yards
- Walk-in Closets



Map is not to scale. Subject to change without notice.

- MODERN DWELLINGS**
- Private Yards*
- BALCONIES**
- PRIVATE GARAGES**
- Community guest parking
- 10-year limited builder warranty
- Sleek modern finishes
- PREMIER video doorbell**
- HONEYWELL LYRIC THERMOSTAT**
- QUARTZ COUNTERTOPS**
- Kitchen Aid appliances*
- BRUSHED NICKEL HARDWARE**
- Schlage Z-Wave Connect entry
- Smooth drywall
- Modern, oversized windows
- SOFT-CLOSING CABINETS**
- Tankless water heater

# PLAN 1

2 Bed / 3 Bath | 1,457 SqFt | 2-Car Garage

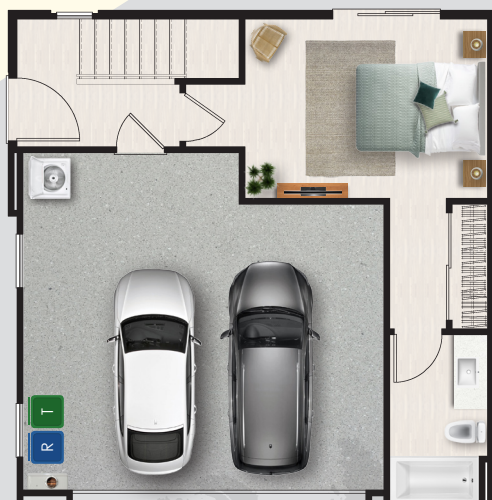

GROUND FLOOR



SECOND FLOOR



THIRD FLOOR

# PLAN 2

3 Bed / 3.5 Bath | 1,799 SqFt | 2-Car Garage



GROUND FLOOR



SECOND FLOOR



THIRD FLOOR



planet home living <sup>SM</sup>

Planet Home Living is a full service real estate and development company dedicated to the creation of unparalleled living environments, specific to the individual and unique lifestyle of each homebuyer.

Our passion is for environmental architecture and craftsmanship that will stand the test of time. As each project, person, and location is unique, it is our commitment to efficiently create stylish, vibrant living environments while invoking emotion and inspiring positive change in the way we live.

**PLANET // LIVING ENVIRONMENT  
HOME // PERSONAL DESIGN  
LIVING // UNIQUE LIFESTYLE**

[f](#) [i](#) PlanetHomeLiving.com

\*Planet Home Living reserves the right to make modifications in materials, specifications, plans, pricing, various fees, designs and scheduling and delivery of homes without notice. Renderings are for illustrative purposes only and not an actual representation of any home. All dimensions and square footages are approximate. Plans and dimensions may contain minor variations from floor to floor. This is not an offer to sell, but for information only. © 2018 All rights reserved.

